

## **BOXY TOTE CLASS**

by Carol Sciarini



### **FABRIC LIST**

Fabric A 1 1/3 yard (The tan fabric)

Fabric B 1 1/3 yard (The black fabric)

Fabric C 1 yard (The red fabric)

Fusible light weight batting 1/2 yard (44 inches wide)

Fusible foam 1 yard (58 inches wide) such as Soft and Stable

Peltex 1/3 yard for bottom of bag. Dawn will have Masonite boards to fit the bottom of the bag if you are using this bag for your Feather Weight. If you are using the board, it is not necessary to purchase Peltex.

24 inch separating zipper

6 Purse feet for the bottom of the bag

"Homemade" Oval and zipper pull

### **SEWING ACCESSORIES**

Thread to match all fabrics

Sewing Machine

Regular foot for straight stitches

Foot for zigzag stitches

Walking Foot

Wonder Clips

Long Straight Pins

Scissors, seam ripper, etc.

Rotary Cutter and Mat (some are available on-site)

Chalk or Fabric Pencil

Iron and Pressing Mat optional (some are available on-site)

### **CLASS PREP WORK**

Allow 4-6 hours for this prep work

Follow the pattern instructions for

- 1) Cutting, labeling The pattern has a sheet of labels that are color-coded and tell you the name of the piece, the size to cut, and how many of each piece to cut.
- 2) Fusing Follow step 1-7 on page 5
- 3) Quilting There is a list in the pattern of the pieces to be quilted. (Page 6, Step 8)
- 4) Handles Sew according to instructions (Page 6, Step 9)

**Don't forget to bring your lunch and any beverages you would like.**

Looking forward to seeing you in class.

# Fusable Foam - Boxy Toke - Cutting Chart

Each square = 1 inch

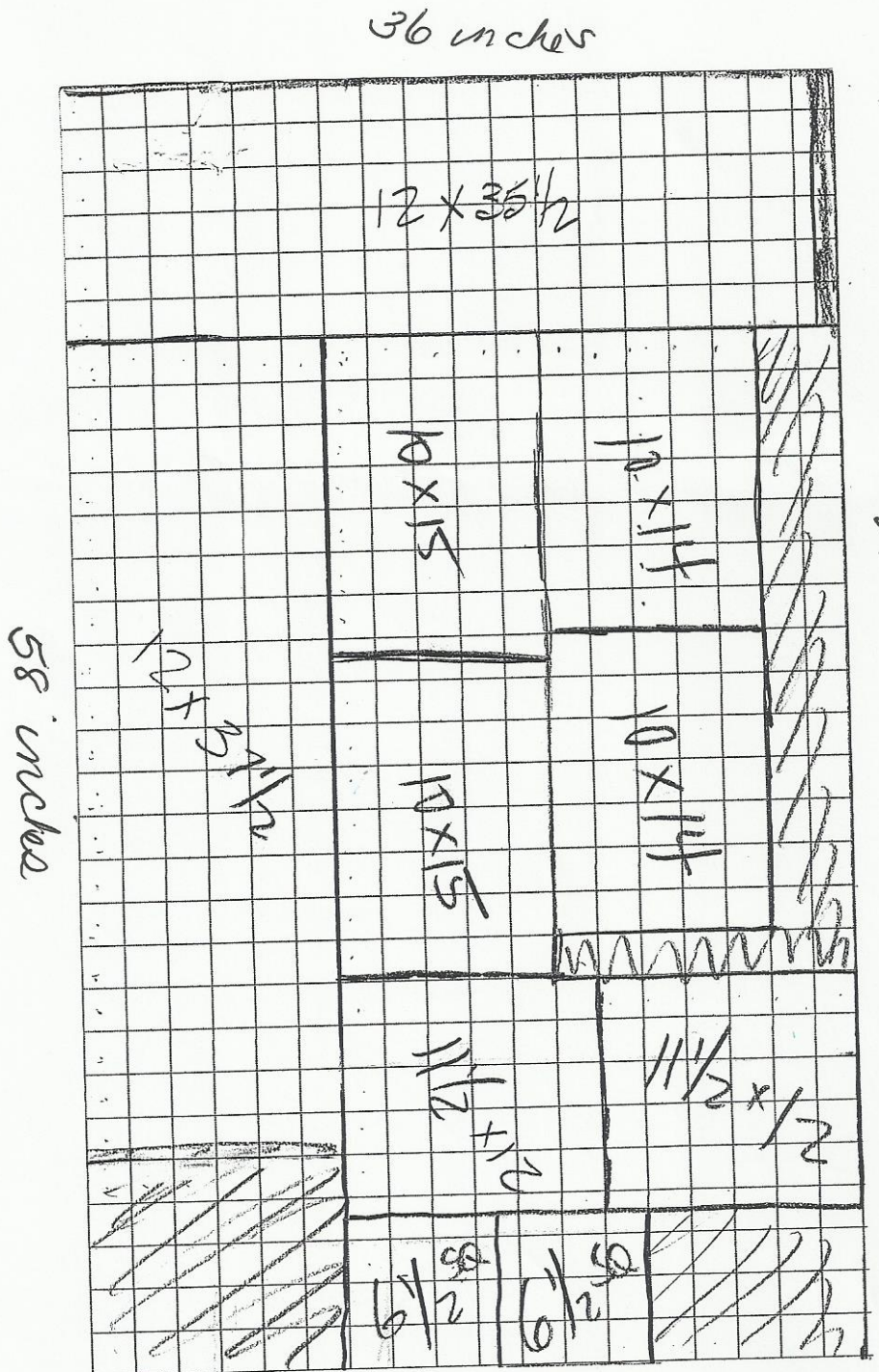

Thanks to Pam Divarnek  
for sharing this chart  
with us 1-24-2018